

---

**KIT PART NUMBER 6730035**  
**INSTRUCTIONS FOR INSTALLING BREWER MOUNTING PLATE**

**CHECK THE PARTS RECEIVED IN THE KIT WITH THE PARTS LIST IN THESE INSTRUCTIONS. IF ANY PARTS ARE MISSING, CONTACT THE NATIONAL VENDORS PARTS DEPARTMENT IMMEDIATELY.**

Read these instructions carefully before installing the kit.  
Keep these instructions for part numbers and for future reference.

**THIS KIT CONTAINS THE FOLLOWING :**

| <b>PART NUMBER</b> | <b>DESCRIPTION</b>             | <b>QUANTITY</b> |
|--------------------|--------------------------------|-----------------|
| 6730037            | TEMPLATE-PUMP MOUNTING         | 1               |
| 1451097            | SCREW-#8-32X.31 HEX HD.TF-BLK. | 2               |
| 6730036            | INSTRUCTIONS-PUMP MOUNTING     | 1               |

1. Turn machine power off.
2. Remove brewer from brewer drive mounting panel.
3. Remove cup station from machine.
4. Remove filter paper cover and filter paper assembly from machine.
5. Remove pump and motor assembly from brewer drive mounting plate.
6. Cutout template part #6730037 as indicated on the template.
7. Align template center hole (141 Dia.) with the existing hole on the brewer drive mounting panel (141 Dia.) and large cutout on the brewer drive mounting panel. (See figure 1 on page 2.)
8. Drill two .141 diameter holes as shown on template.
9. Install pump and motor assembly on the brewer mounting plate using existing screw that was removed and the two other screws part# 1451097 that are supplied. (Caution: make sure that all metal shaving are cleaned up.)
10. Install filter paper assembly, filter paper cover, and cup station back in the machine.
11. Restore power back to machine and check brewer assembly for proper operation.

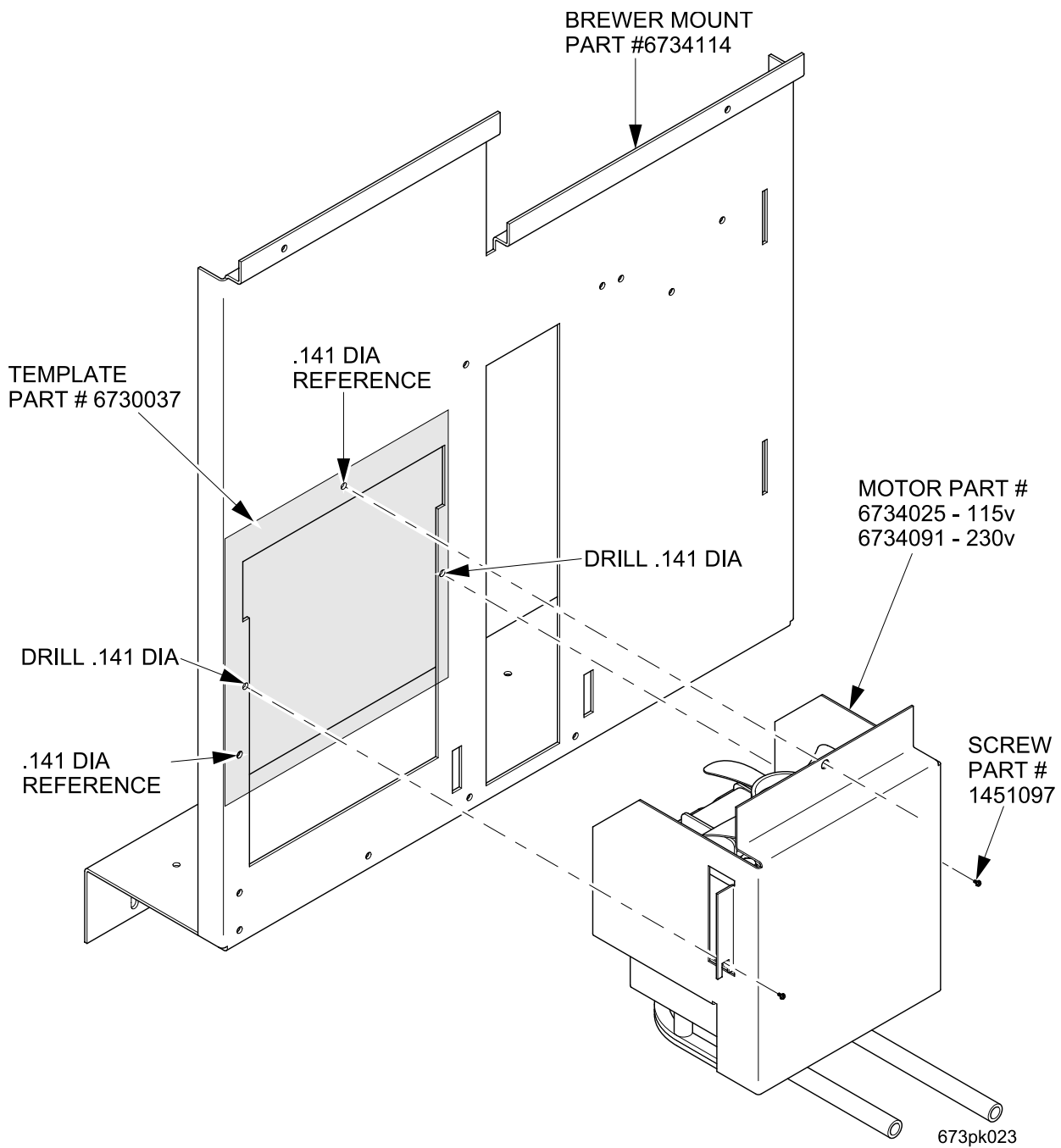

Figure 1